

WATER PURIFIER **Instruction Manual**

Model: MU151-4

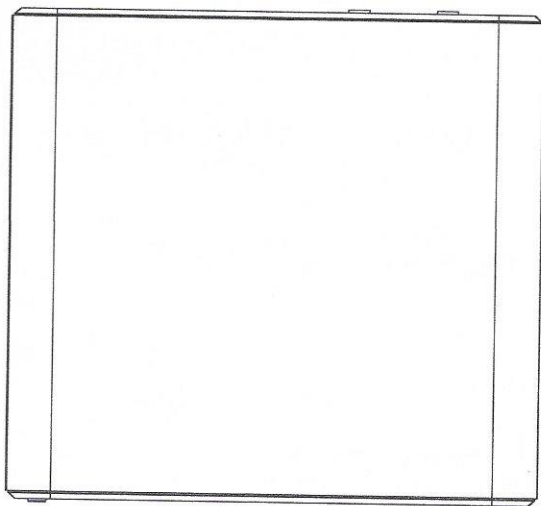

The diagram above is just for reference. Please take the appearance of the actual product as the standard.

Before installing and operating your water purifier, please read the instruction manual carefully and keep it for future reference.

TABLE OF CONTENTS

	page
Safety instructions.....	1
Product overview	2
Before first use.....	4
Preparation	4
Connection diagram	4
How to use the quick-connect fittings	5
Installation	6
Using the product	8
Maintenance (Filter replacement)	9
Troubleshooting	9
Cleaning.....	10
Specifications	10
Disposal.....	10

The packaging materials are recyclable, we recommend that you separate plastic, paper and cardboard and place into proper recycling containers.

SAFETY INSTRUCTIONS

● Please note the following brief icons and rules for safe use of this product



Troubleshooting

When the machine fails, please disconnect the water source immediately



Maintenance

Never remove the parts on the machine to avoid leakage or damage



Avoid contact with children

Never have the machine operated by a child



Temperature

Please use the product in a dry place with the water temperature of 5-38 °C



Moisture

If the machine is not in use for a long time, keep the RO membrane humid



Accessories and filter cores

To maintain the normal operation of the machine, be sure to use accessories and filter cores supplied by this company



Emergency call

For any help, please call the local sale service center



Correct repair service

This machine can only be repaired by qualified personnel designated by this company

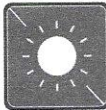

Avoid direct sunshine

Do not install the machine in a place exposed to direct sunshine



Anti-freeze

Never store or expose the product in an environment less than 0°C

1. This appliance can be used by children aged from 8 years and above if they have been given supervision or instruction concerning use of the appliance in a safe way and if they understand the hazards involved. Cleaning and user maintenance shall not be made by children unless they are older than 8 and supervised. Keep the appliance and its cord out of reach of children aged less than 8 years.
2. Appliances can be used by persons with reduced physical, sensory or mental capabilities or lack of experience and knowledge if they have been given supervision or instruction concerning use of the appliance in a safe way and understand the hazards involved.
3. Children shall not play with the appliance.
4. Do not store explosive substances such as aerosol cans with a flammable propellant in this appliance.
5. This appliance is intended to be used by expert or trained users in shops, in light industry and on farms, or for commercial use by lay persons.
6. The appliance is suitable for indoor use only.
7. **WARNING:** Keep ventilation openings, in the appliance enclosure or in the built-in structure, clear of obstruction.
8. The appliance must not be immersed.
9. **WARNING:** To avoid a hazard due to instability of the appliance, it must be fixed in accordance with the instructions.
10. The appliance must not be cleaned by a water jet.
11. The appliance must not be immersed.
12. The new hose-sets supplied with the appliance are to be used and that old hose-sets should not be reused.
13. The maximum inlet water pressure 57 psi(0.4MPa);
14. The minimum inlet water pressure 14.2 psi(0.1MPa);
15. If the pressure is higher, it's recommended to add a pressure reducer before the product by the consumer.

PRODUCT OVERVIEW

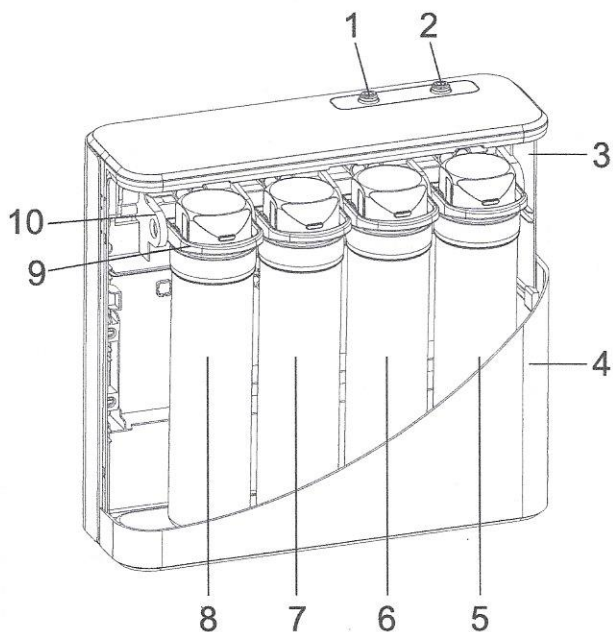

Part	Description
1	UF purified water outlet
2	Tap water inlet
3	Back panel
4	Front panel
5	PP filter
6	Post carbon filter
7	Pre active carbon filter
8	UF filter
9	Holder for filter
10	Water flow system

Note: Please use the product in a place with temperature of 5–38 °C and relative humidity less than 90%.

*** To enhance product performance, product parts may be changed without notice.
The object shall prevail.**

PRODUCT OVERVIEW

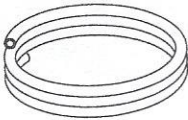

PE-tube
WHITE: TAP WATER

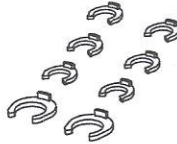

Locking clip (8x)

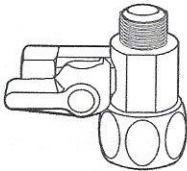

3-way valve

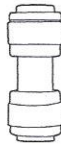

Union connector

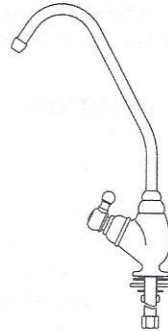

Faucet

Required tools (not included)



Power drill with 1/4" drill bit



Bucket

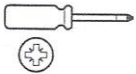

Cross-head screwdriver

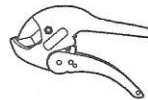

Pipe cutter



Adjustable wrench



Safety glasses

BEFORE FIRST USE

⚠ WARNING To avoid danger of suffocation, keep plastic bags away from children and pets. Do not use plastic bags in cribs, beds, carriages or playpens.

1. Remove all the packing materials.
2. Remove and review all components before use.
3. Check the product for transport damages.

PREPARATION

1. This product should be installed and maintained only by an experienced adult following Uniform Plumbing Code (UPC) or other applicable state or local codes. If in doubt, consult a professional.
2. Ensure the mains water supply meets the product requirements, see chapter **Specifications**.
3. It is recommended to place the main unit in the cabinet under a sink on a flat and level surface. Before starting the installation, place the product in its planned location to ensure the location is suitable.
4. Ensure there is sufficient access to the plumbing under the sink and the main water valves.
5. Ensure the PE-tubes can be routed without kinking or bending.
6. Ensure all required tools are available before starting the installation.

NOTICE It is normal for the water purifier to emit some noise and slightly vibrate when in use, this is normal.

CONNECTION DIAGRAM

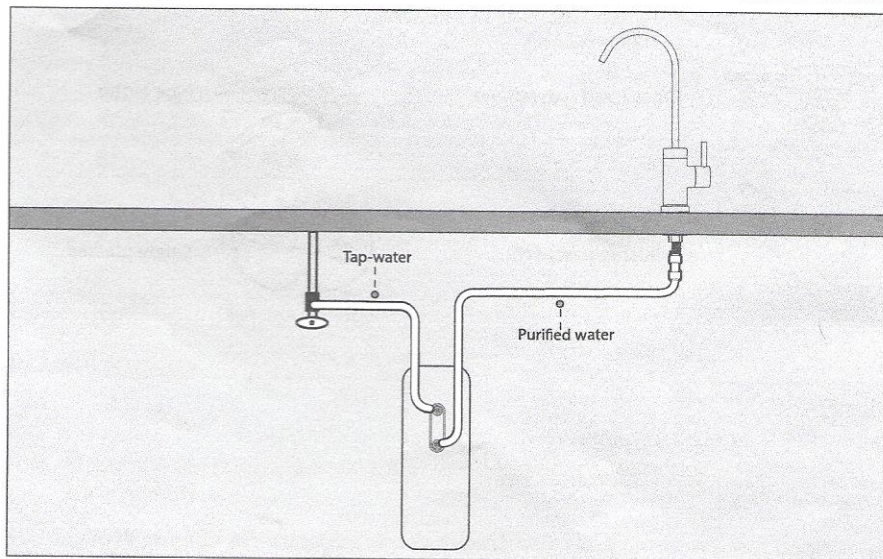

HOW TO USE THE QUICK-CONNECT FITTINGS

All parts of the product that connect with PE-tubes are equipped with quick-connect fittings.

To attach a PE-tube to a quick-connect fitting:

1. Push the PE-tube into the fitting. There is an existing mark at the end of the tube for you to confirm if the tube is fully inserted into the fitting.
2. Slide the Locking clip between the quick-connect release and the fitting (Fig.1).

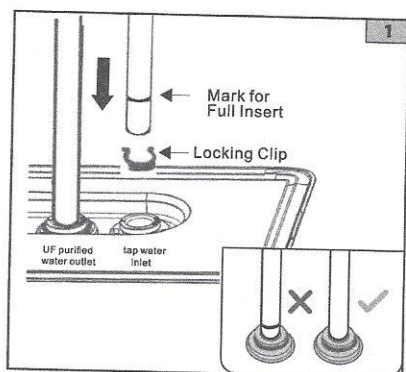

To disconnect a PE-tube from a quick-connect fitting:

1. Remove the locking clip.
2. Push and hold the quick-connect release.
3. Pull the PE-tube out of the fitting (Fig. 2).

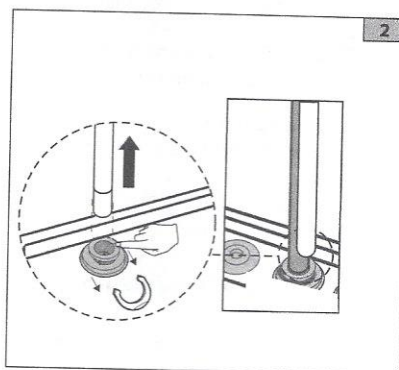

INSTALLATION

Step 1: Installing the 3-way valve

NOTICE The 3-way valve has a threaded diameter of 3/8" and can be converted to 1/2" using the provided 1/2" adapter.

1. Locate the cold water supply shut-off valve under the sink and close it.
2. Open the sink faucet to release remaining pressure in the cold-water line. Make sure the pressure has been released before proceeding to the next step. Have a bucket ready to capture any water left in the water line.
3. Use an adjustable wrench to unscrew the cold-water line from the water supply shut-off valve.
4. Wrap the threads of the 3-way valve with thread seal tape.
5. Remove any old thread seal tape from the water supply shut-off valve.

NOTICE The 1/2" adapter and small rubber gasket can be either placed on top of the 3-way valve (Fig.3-A) or on top of the water supply shut-off valve (Fig.3-B).

6. Place the medium rubber gasket on the water supply shut-off valve and screw the 3-way valve onto the water supply shut-off valve using an adjustable wrench. Make sure that the 3-way valve is connected securely. Do not over tighten the connections, this may damage the fittings (Fig. 3).
7. Connect one end of the tap-water PE-tube (WHITE) to the 3-way valve by pushing it into the quick-connect fitting. Secure the PE-tube with the safety clips. (see chapter **How to use the quick-connect fittings**) (Fig. 4).

NOTICE Do not connect the other end of the PE-tube to the main unit (4) at this time.

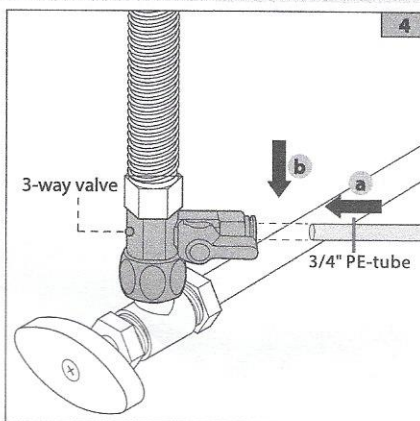
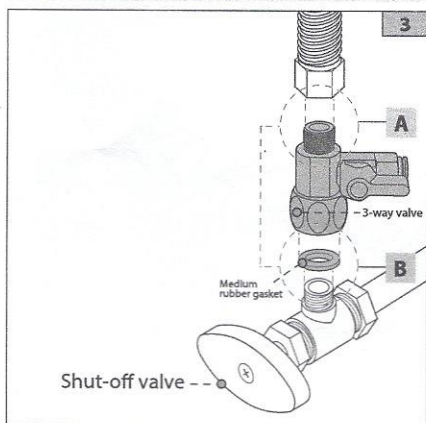

9. Wrap the thread seal tape in the direction of the thread counterclockwise.
10. When wrapping thread seal tape, wrap threads 8-10 turns.

INSTALLATION

Step 2: Installing the faucet

CAUTION Risk of damage!

Some kitchen counter top materials, including granite, porcelain, steel and plastic resin, require specialized tools and can be irreparably damaged if unsuitable tools are used.

Installing the faucet requires a hole in the counter top or sink. The hole size must be 1" in diameter.

1. Use a pre-existing hole if available. If no pre-existing hole is available, consider hiring a professional.
2. Place the large rubber gasket over the hole and place the stem of the faucet through the hole (Fig. 6).
3. Faucet installation:
Step 1: Before placing water faucet in hole, install decorative washer and gasket, shown in figure 7, to the base of the water faucet.
Step 2: Position and center the water faucet above countertop hole and slide faucet into place. On the base of the faucet, install the plastic gasket, metal washer and nut accordingly (see figure 7). Hand-tighten nut, adjust the position of the faucet to make sure the faucet is centered in hole and spout is pointed towards the sink. Once faucet is in correct position, tighten nut. (Note: be careful not to over-tighten nut may damage countertop material.)

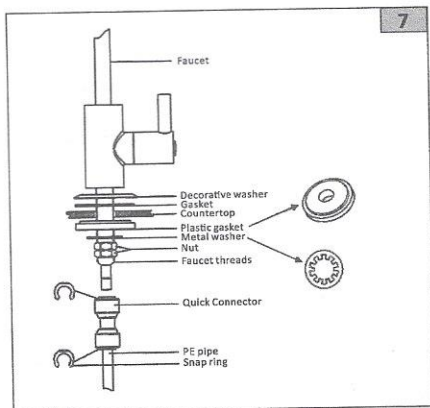
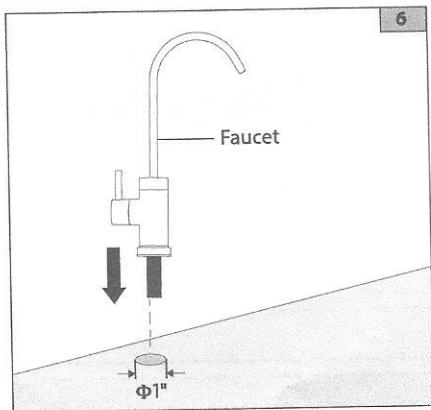

4. Connect one end of the Blue purified water PE-tube to the faucet by pushing it into the quick-connect fitting. Secure the PE-tube with the safety clips (see chapter **How to use the quick-connect fittings**).

NOTICE Do not connect the other end of the PE-tube to the main unit at this time.

INSTALLATION

Step 4: Connecting the PE-tubes to the main unit

The main unit has, **Purified water** outlet and **Tap-water** inlet.

These correspond to the two PE-tubes.

1. Remove the protective silicon plugs from the inlet and outlets on the main unit (Fig. 8-a)
2. Push the tap-water PE-tube into the quick-connect fitting of the tap water inlet (Fig. 8-b). The other end of the tap-water PE-tube is connected to the 3-way valve.
3. Push the UF purified water PE-tube into the quick-connect fitting of the UF purified water outlet. The other end of the UF purified water PE-tube is connected to the faucet.
4. Secure each of the PE-tube with the safety clips (see chapter **How to use the quick-connect fittings**).

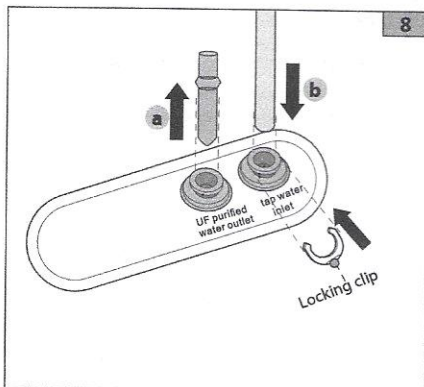

Step 5: Checking for leaks

1. Close the faucet.
2. Open the 3-way valve and the water supply shut-off valve (Fig. 9).
3. Check all connection points for any leaks.
4. Use the water supply shut-off valve to turn off the water supply if any leaks are spotted.

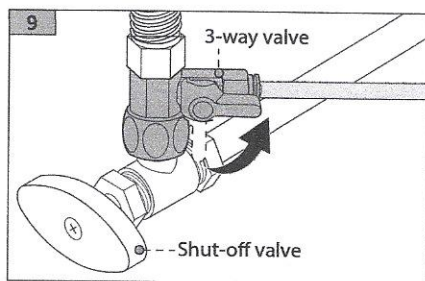

USING THE PRODUCT

CAUTION Risk of damage!

- Close the 3-way valve and disconnect the product in the event of a water shutdown or pipeline maintenance. Always flush the water lines after any maintenance work has been carried out to avoid larger debris to enter the filters.
- If you plan to not use the product for an extended period of time, close the 3-way valve. Before using the product again, open the 3-way valve and allow the water to run through the faucet for 3 to 5 minutes.

MAINTENANCE (FILTER REPLACEMENT)

1. When the filter lifetime is expired and the filter should be changed in time. Close the inlet ball valve, close the tank ball valve.

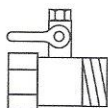

Close the inlet
ball valve

2. Lift up the handle, take out of the cartridge and put the new one into the head groove, then push the into the double hole, push down the handle until you hear a SNAP and the level is past the bump on the filter heat.

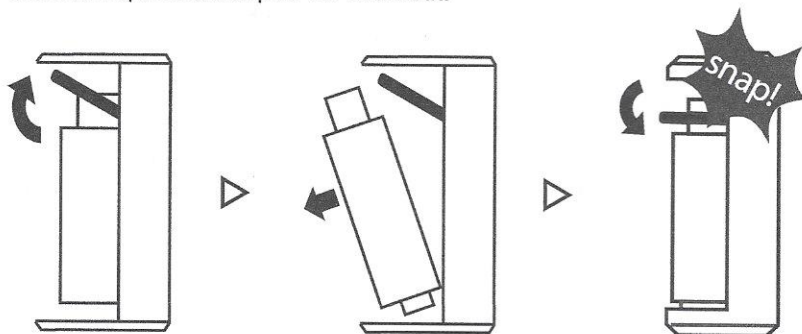

3. When the filter replacement is finished. follow the "HOW TO USE" step to operate.

TROUBLESHOOTING

Issues	Reason	Trouble Shooting
No flow or low flow	1. Filter is blocked 2. Filter lifetime is expired.	1. Check water supply is available. 2. Replace filters
Filtration system runs constantly for a long period of time (>8hrs)	No water in the line	1. Check water supply is available.

CLEANING

- Do not use any aggressive cleaners, brushes with metal or nylon bristles, or sharp or metallic cleaning utensils such as knives, hard scrapers, and the like. They could damage the surfaces.
- Use a damp cloth to wipe off the of the product. Let the product dry completely.

SPECIFICATIONS

MODEL	MU151-4
Clean water flow rate	1.2L/min
Water type	potable tap water
	TDS≤350ppm
Rated purified water	3600L
Inlet water pressure	0.1-0.4MPa
Applicable water temperature	5-38℃

DISPOSAL

Disposing of the product

Should the product no longer be capable of being used at some point in time, dispose of it in accordance with the regulations in force in your city or county. Ensure your recycling information applies to the local regulations.

The product is subject to change without notice.